

TMX Series Carbs

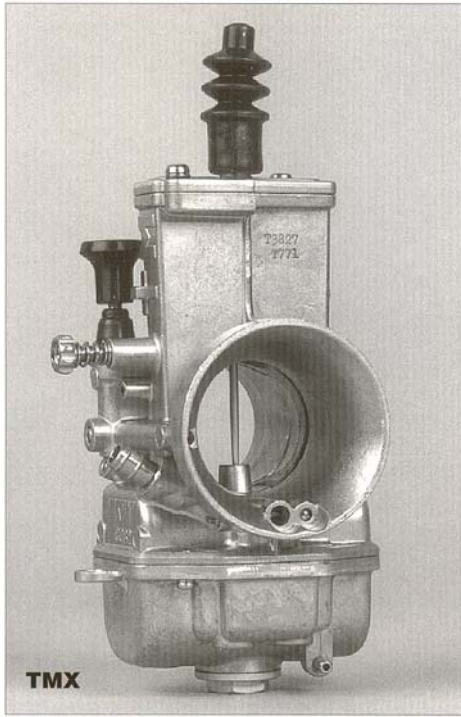

TMX

TMX35/38mm CARBURETORS FOR DIRT BIKES and ATVs

The TMX features a flat slide design in a smooth bore venturi to provide improved throttle response and wider powerband. The float system with independently moving floats, working with a main jet enclosed in a baffle chamber, allows the TMX to perform smoothly without hesitation on the roughest terrain. TMX Series Carburetors are available in 35mm bore sizes for 125cc race engines, and in 38mm bore sizes for use on 250cc race engines.

STANDARD SETTINGS

CARB NO.	MAIN JET 4/042	PILOT JET VM22/210	JET NEEDLE	THROTTLE VALVE
TM35-1 *(Kit No. TMX35-1-k)	350	20	6EN11-53	999-832-014-6.0
TM38-18 *(Kit No. TMX38-18-k)	370	20	6EJ12-55	999-832-014-3.5
TM38-27 *(Kit No. TMX38-27-k)	370	20	6EJ12-55	999-832-014-3.5

*NOTE: COMPLETE KIT INCLUDES AIR BOOT ADAPTER, INNER THROTTLE CABLE WIRE, CABLE END, MAIN JETS, PILOT JETS, JET NEEDLE, CLAMPS, HOSE AND INSTRUCTIONS.

Mikuni TMX Series Carburetors are intended for off-road riding and racing use only. Not legal for sale or use in California or other locations where similar pollution laws may apply.

TMX/TMS SERIES CARBURETOR DIMENSIONS (mm)

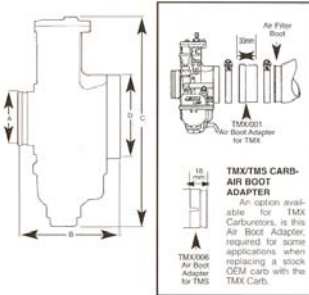

MODEL	TMX35	TMX38-27	TMX38-18
DIMENSION	-1		
A	40	44	47
B		76	
C		164	
D		62	
TOTAL WIDTH		76	

IMPORTANT TUNING CHARACTERISTICS

JET NEEDLE

The Jet Needle is the tapered rod that is positioned in the throttle valve by the 'E'-Clip. The taper of the needle increases the clearance between the Jet Needle and the fixed Needle Jet outlet as the throttle is opened. As the air flow volume increases past the throttle slide, the fuel volume is also increased to maintain the correct air/fuel ratio.

NEEDLE 'E'-CLIP POSITION

The position of the 'E'-Clip in the Jet Needle is used to correct or change the air/fuel ratio between 1/4th and 3/4th throttle valve position. The 'E'-Clip can be raised or lowered on the Jet Needle to richen the fuel mixture the 'E'-Clip is lowered on the Jet Needle, raising the Jet Needle. To lean the fuel mixture the 'E'-Clip is raised on the Jet Needle.

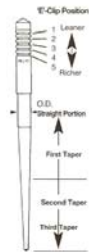

JET NEEDLES

To correct the fuel mixture at 1/8th to 1/4th throttle slide position it may be necessary to change the Jet Needle. The Jet Needle will have a series of numbers stamped on it.

Example: 6EJ12-55. The numbers 55 indicate that the outside diameter (O.D.) of the Jet Needle is 2.55mm. A smaller O.D. number gives a richer mixture. A larger O.D. number gives a leaner mixture. Typical Jet Needles available:

TMX35	TMX38
6EN11-58 Leaner	6EJ12-60 Leaner
6EN11-57	6EJ12-59
6EN11-56	6EJ12-58
6EN11-55	6EJ12-57
6EN11-54	6EJ12-56
6EN11-53	6EJ12-55
6EN11-51 Richer	6EJ12-54
	6EJ12-53 Richer

Parts

TMX35/38 Series Exploded View

MIKUNI TMX SERIES PART LIST

No.	Description	Part Number
1.	MIXING BODY CARB	TM28SS44
2.	JET NEEDLE	J8-SEE TUNING
3.	COVER, CARB TOP	776-19014
4.	LOCK NUT, ADJUSTER	B30/247
5.	CAP, RUBBER	VM34/282
6.	ADJUSTER, CABLE	VM30/77
7.	O-RING, TOP COVER	616-93009
8.	E-RING, NEEDLE CLIP	BS32/126
9.	RING, RETAINING	TM38/54
10.	ADJUSTER, IDLE STOP	603-25008
11.	SPRING, IDLE ADJUST	N110209
12.	PLUNGER, STARTER ASSY	TM38/57
13.	SCREW, AIR ADJUSTER	603-36002
14.	SPRING, AIR SCREW	VM15/112
15.	CHAMBER, FLOAT BOWL	TM38/48
16A.	VALVE SEAT, NDLE ASSBLY	786-36004-(3.5)
16B.	VALVE SEAT, NDLE ASSBLY	786-36004-A-(1.8)
17.	PILOT JET	VM22/210-SEE TUNING
18.	MAIN JET	4/042-SEE TUNING
23.	CAP, FLOAT RETAINER	VM26/42
24.	SCREW, TOP COVER	CW2-0412
25A.	THROTTLE VALVE	999-832-014
25B.	THROTTLE VALVE	999-832-017
26.	SPRING T.V.	730-13019
27.	HOSE, VENT	888-24011
28.	SCREW, FLOAT BOWL	CW2-0308
29.	HOSE, OVERFLOW	888-23022
30.	FLOAT, LEFT SIDE	859-52021
31.	O-RING, DRAIN PLUG	BN042/64
32.	DRAIN PLUG	TM38/44
33.	FLOAT, RIGHT SIDE	859-52020
34.	GASKET, FLOAT BOWL	TM38/52

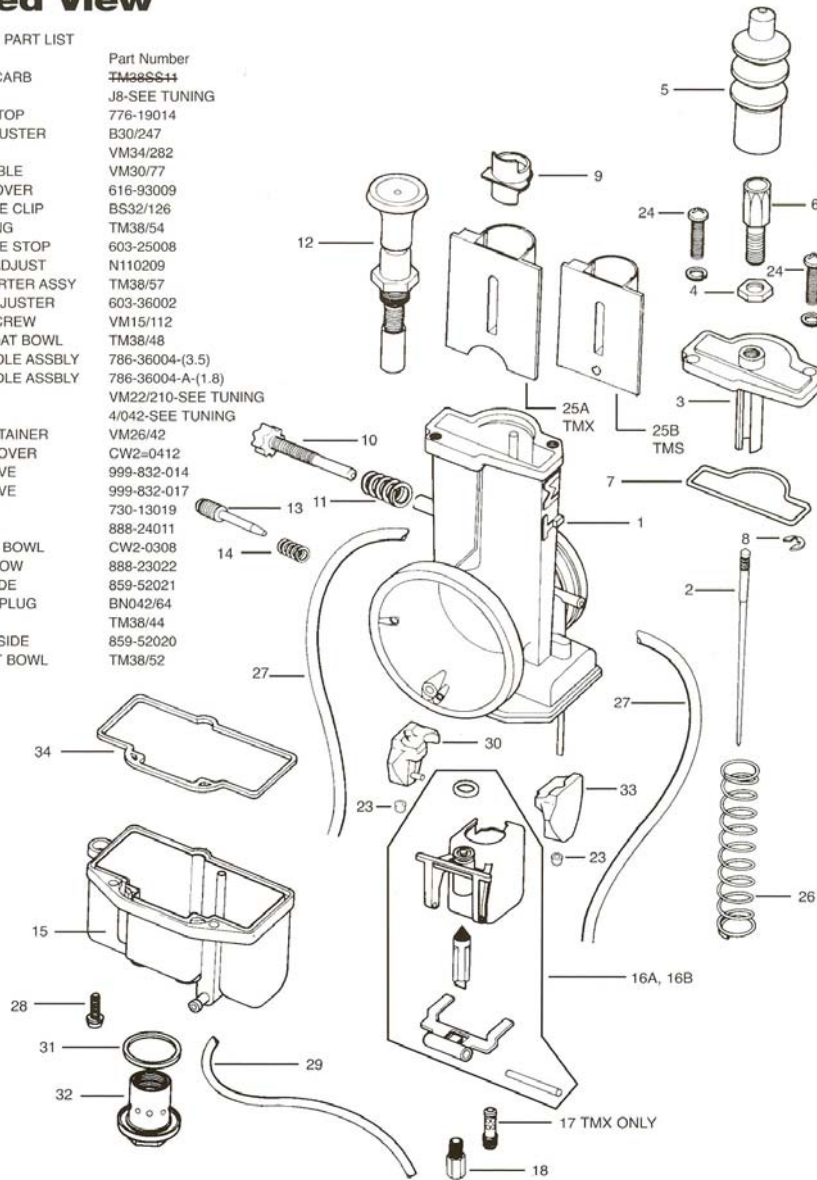

PART NUMBER 999-999 = NO AVAILABLE STOCK